

1

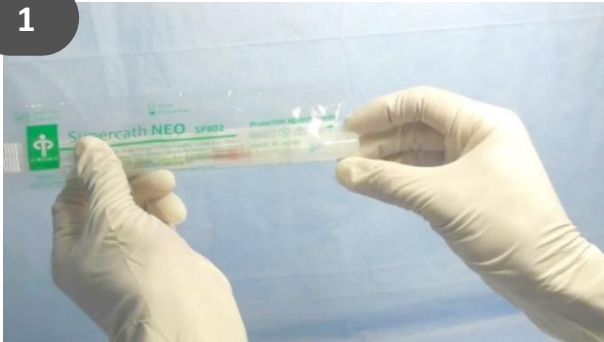

Take the Supercath NEO out.

2



Remove the protector taking care not to damage the needle tip.

3

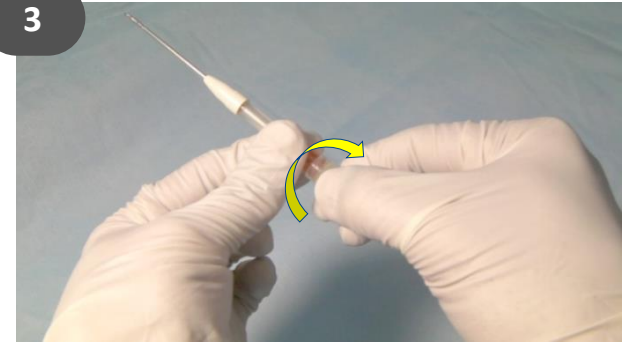

Holding the luer connector, check that the rubber adapter and the luer connector have engaged securely.

4

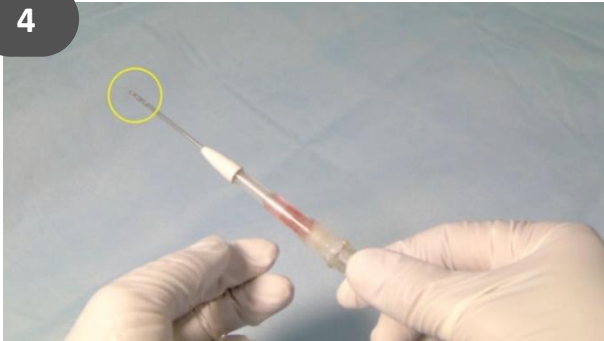

Check the condition of the inner needle tip.

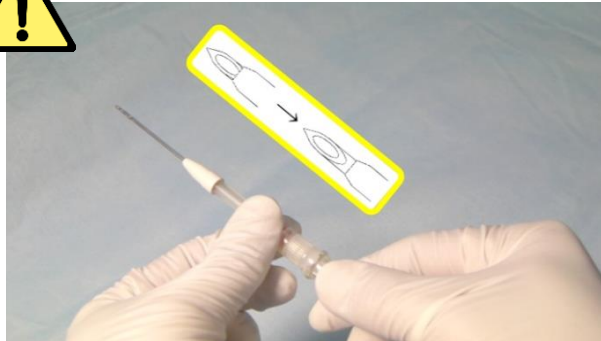

If the catheter tube tip covers the inner needle tip, pull the luer connector back until it touches the hub.

5

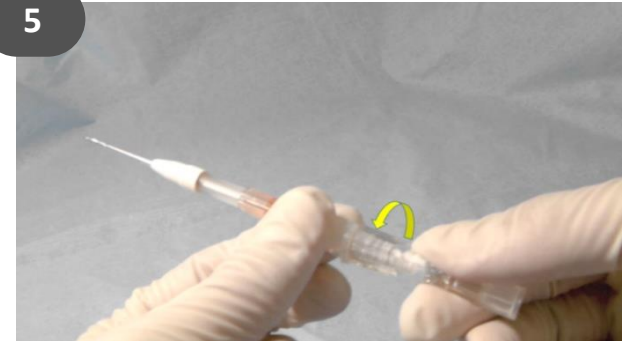

Move the hub counterclockwise to remove any adhesion between the inner needle and the outer needle.

6



Holding the hub with the inner needle blade directed upwards, aim at the blood vessel, and puncture the skin with the needle.

7



Check the blood backflow into the hub and further insert the catheter tube up to the required depth into the blood vessel.

8



Holding the rubber adapter with one hand, grasp and pull the hub with the other hand until the tip of the metal inner needle is in the luer connector.

9



Clamp the center of the clamping tube to prevent any bleeding and promptly pull out the inner needle.

10



Hold the clamping tube when removing the rubber adapter.

11



Cautiously loosen the clamp on the clamping tube to release the air from the outer needle.

12



Attach the connector of the blood circuit securely to the luer connector and tighten the lock nut.

13



Secure the outer needle and blood circuit tube with tape.
✘ Please follow the instructions specified by your facility.



MEDIKIT
MEDIKIT EUROPE GMBH

Gerbermuehlstraße 7
60594 Frankfurt am Main
www.medikit-europe.de
Manufacturer: Togo Medikit Co., Ltd.